



HONYA Lighting

Project Name: _____

Date: _____ Note: _____

LED UP and DOWN SUSPENDED LINEAR LIGHT



Application: supermarket, warehouse, office, factory, commercial and industrial space

Certification



SPECIFICATION

Model No	HY-4FT-LUD-50W-30K/40K/50K
Power	50W
Input Voltage	AC 110-277V
Luminous Flux	50W-6101.64 lm 30% up & 70% down
Efficiency	129.19 lm/W
Power Factor	>0.9
CCT	CCT Selectable: 3000K/4000K/5000K
CRI	>80
Working Life	>50,000 hours
Working Temperature	-10°F to 105°F
Protection Level	Dry/Damp Location
Dimming	0-10V Dimmable
DLC ID	PYOC8G5A
Qty/Pack	4
Package Size	49.5"x7.5"x7.7"
Package Weight	36 LB

FEATURE

- Stylish Architectural design and white finish
- High luminous efficacy: 125 LM/W
- Linkable: seamless continuous linking feature
- 0-10V Dimming
- The IP40 rating offers extra protection for school applications
- Installation: Suspended (Aircraft Cable Kit included)
- Suitable for dry/damp location

ACCESSORIES

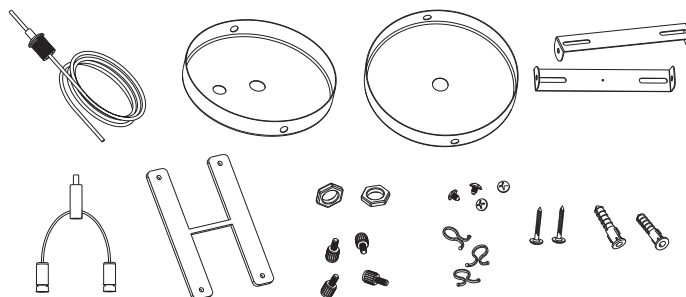

ORDERING CODE DEFINITION

EXAMPLE: HY-4FT-LUD-50W-30K/40K/50K

Company Code	Length	Product	Wattage	CCT
HY	4FT	LUD: up and down linear light	50W	CCT Selectable: 3000K/4000K/5000K

PRODUCT DIMENSIONS

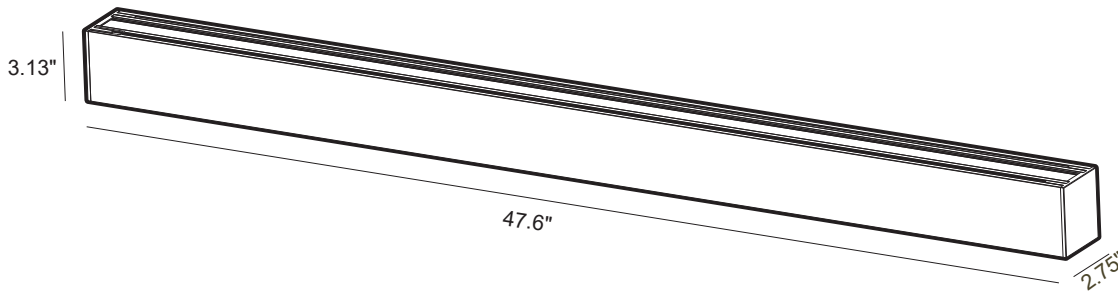

INSTALLATION INSTRUCTION

WIRING

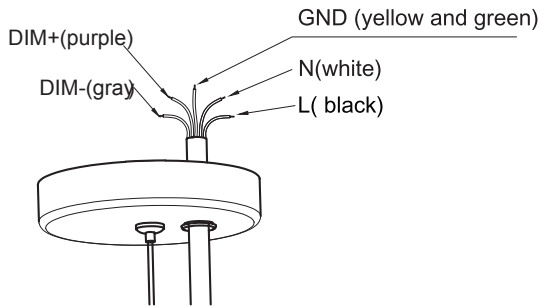

CCT Tunable

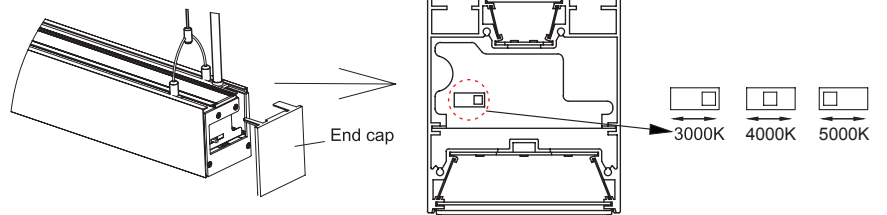

Connection Instruction

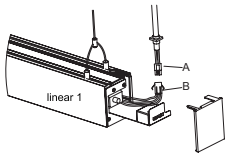

Disconnect the A and B parts.

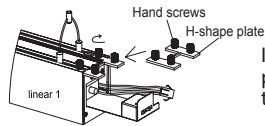

Insert the H-shape plate to the track as the picture shows.

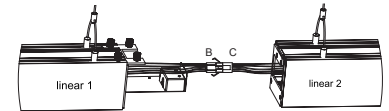

Install the Linear 2 to the ceiling and open the end cap, connect B and C as the picture shows.

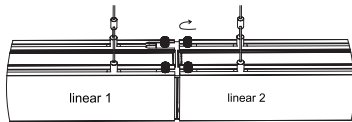

Push back Power Supply Board to Linear 1 then insert the H-shape plate to Linear 2, tighten the plate with 4 pcs hand screws.

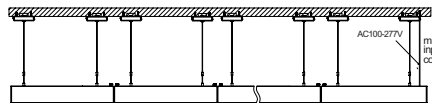

Install the Linear Light as above method, keep one main input cord on one side.

NOTE: LED LINEAR CAN BE JOINED TOGETHER AS NEEDED, BUT THE TOTAL NUMBER OF FIXTURES SHOULD BE NOT MORE THAN 7PCS

PHOTOMETRIC REPORT

