

LED Ultra-Thin Downlight



Trim Color Available



Application: Commercial; Residential; hospitality

Specifications

SKU	HY-DL-10W-R	HY-DL-12W-R	HY-DL-18W-R
Model No.:	JXL-TZ04-T10W-UHD	JXL-TZ06-T12W-UDH	JXL-TA08-T18W-UDD
Power:	10W	12W	18W
Input Voltage:	120V AC, 50/60HZ		100-130V AC, 50/60HZ
Lumen	700LM	900LM	1350LM
Halogen Equivalent	70W	75W	120W
Power Factor:	0.95		
Beam Angle	110°		
CCT:	3000K/4000K/5000K		
CRI:	>82Ra		
Working Life:	70% light output at 50000hrs		
Product Size:	φ4.8"x 0.78"	φ6.85"x 0.91"	φ8.78"x 0.94"
Qty/Master Pack	20	20	10
Master Pack Size:			
Master Pack Weight			

DESCRIPTION

The ultra slim LED downlights/surface mini panel comes with separate steel encased LED driver with watertight seal. Commercial grade quality with architectural design

FEATURES

- 1" Thin: Fits in Tight Ceiling Space.
- Airtight & Type IC Rated: No housing Required
- Snap-in mounting springs and easy wiring access for fast & easy Installation: Save labor cost.
- Junction Box Included: No additional hardware required.
- Damp location rated and dimmable with approved dimmers
- ETL-listed: reliable quality and safe operation. Suitable for damp locations
- Body: Durable, die cast aluminum alloy for optimal heat dissipation
- White, Nickel or Black for choice--Scratch resistant and smooth finish

Ordering Guide

Model No: HY-DL-(xx)W-R-(xx)K					
Company Code	Product	Size	Watt	Shape	C.C.T.
HY	DL: Ultra-Thin Downlights	4 inch	10W	R: Round	30K: 3000K
		6 inch	12W		40K: 4000K
		8 inch	18W		50K: 5000K

DIMENSION

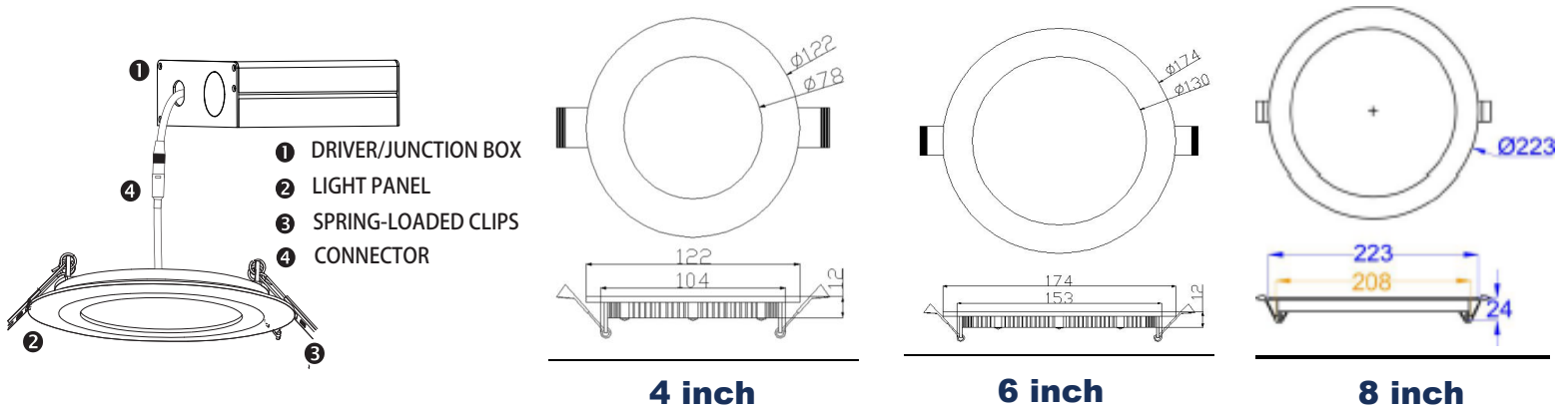

INSTALLATION

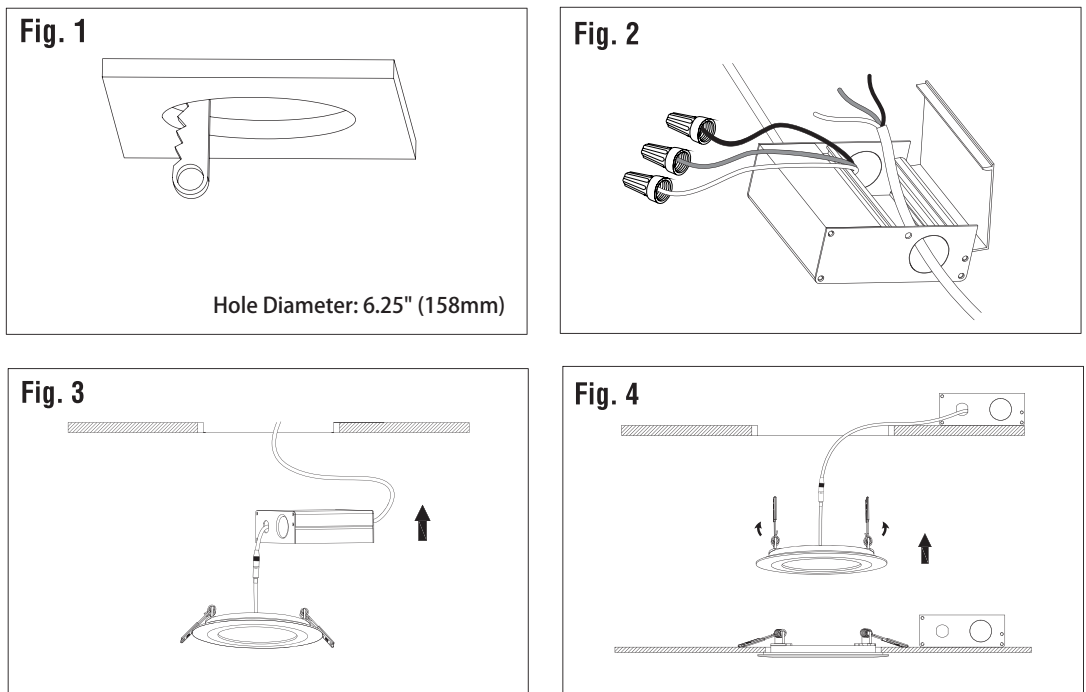

1. Turn off the power before installation.
2. Remove the existing fixture if applicable or determine the location for installation and cut ceiling hole (Fig. 1)
3. Open the DRIVER/JUNCTION BOX cover and remove the appropriate knockout(s) on the side panel. (Fig. 2)
4. Insert the electrical supply cable through the knockout and connect the ground wire to the green wire terminal, hot wire to the black wire terminal and neutral wire to the white wire terminal using the wire nuts provided.
5. Place all wiring and connections back into the box and close the cover. Connect the DRIVER/JUNCTION BOX to the light panel using the CONNECTOR.
6. Insert DRIVER/JUNCTION BOX through the mounting hole (Fig. 3) and secure using mounting tabs.
7. Push the SPRING-LOADED CLIPS into the mounting hole upwards and insert LIGHT PANEL into it. Release the clips and the fixture will be pulled flush to the ceiling. (Fig. 4)

LIGHT DISTRIBUTION

