

LED AREA LIGHT -300W



CERTIFICATIONS



MODEL#: NSL-LD-300W-27-50K-X-TX-X-X

Specifications:	
SKU:	NSL-LD-300W-27-50K-X-TX-X-X
Power:	300W
Input Voltage:	AC100-277V
Luminous Flux:	37,993 Lumens
Efficacy:	128.96 lm/W
Power Factor:	0.927
Driver Efficiency:	>90%
CCT:	5000K
CRI:	Ra>70
Total Harmonic Distortion:	18.11%
LED Brightness Decay:	<5%/6,000 hours
Working Life:	>70,000 hours
Working Temperature:	-30°F to 105°F
Protection Level:	Wet Location/IP65
IK:	IK09
EPA:	0.48-0.59 sq. ft
Cable:	3 core, 18AWG
Product Size:	25.39" x 15.35" x 5.91"
Packing Size:	27" x 19" X 8"
Net Weight:	25.35lb
Gross Weight:	30lb
DLC Product ID:	PUKSQ8OU



Product Abstract:

Accord Series Area Light features outstanding photometric performance, excellent uniform illumination, low profile construction, high efficacy and long lifespan. Our new area light series reduces the size and weight of your parking lot lights while maintaining high lumen output. The compact one-piece die-cast aluminum housing with UV resistant powder coat finishing offers outstanding corrosion protection. The advanced optical lens provides excellent light distribution and least lumens decay. Utilizing the latest LED technology and integrated cooling designs, it's ideal for commercial lighting application.

Application: Parking lots, buildings, building facades, parks and much more.

Mounting Height: 25' to 40'

Led characteristics:

- Phillips Lumileds LED, high luminous efficacy and long working life.
- 70,000+ hour LED lifespan based on IES LM-80 results and TM-21 calculations.
- LED color temperature is warrantied to shift no more than 200K in CCT over a 5-year period
- Our range of CCT (Correlated Color Temperature) follows the guidelines of the American National Standard for Specifications for the Chromaticity of Solid State Lighting (SSL) Products, ANSI C78.377-2015.

Construction:

- Minimum starting temperature is -30°F
- Suitable for use in 105°F ambient temperatures
- Superior thermal management with external Air-Flow fins
- Die-cast aluminum housing and mounting arm.
- Arm mounting, slip-fitter mounting, trunnion mounting
- High-temperature silicone gaskets
- Ingress Protection rating of IP65 for dust and water
- Formulated for high-durability and long-lasting color
- Mercury and UV free. RoHS compliant components. Polyester powder coat finish formulated without the use of VOC or toxic heavy metals.

Optics:

- UV coated prismatic polycarbonate diffuser
- Excellent Optics design, greatly improve the light utilization and evenness
- Lighting Angle Available Type III & Type V distribution

COMPARISON TABLE

Type	Wattage	Energy Saving (%)	L70 Life Span
Accord Series - 39,000 Lumens	300W	--	>70,000 Hours
1000W Metal Halide	1,081W	70%	10,000 Hours
1000W High Pressure Sodium	1,081W	70%	20,000 Hours

LAMP CODE DEFINITIONS

Series	Power	Voltage	Color Temp.	Finish	Distribution	Mounting	Control
NSL-LD: AAL shoe box area light	300W	27: AC100-277V	50K: 5000 Kelvin	D: Dark Bronze B: Black W: White	T3: Type III T5: Type V	S: Slip Fitter A: Arm T: Trunion	(blank): no controls P: 110-277VAC photocell

PRODUCT DIMENSIONS

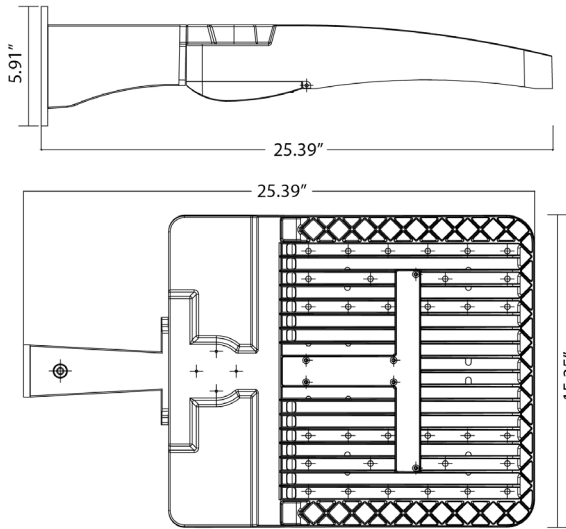

SLIP FITTER DIMENSIONS

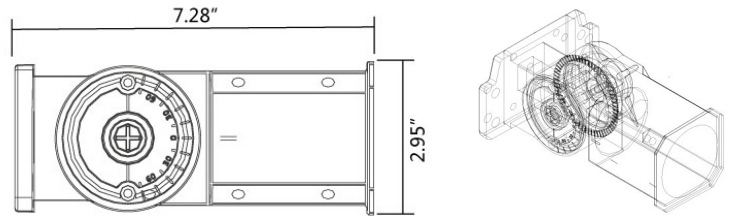

TRUNNION DIMENSIONS

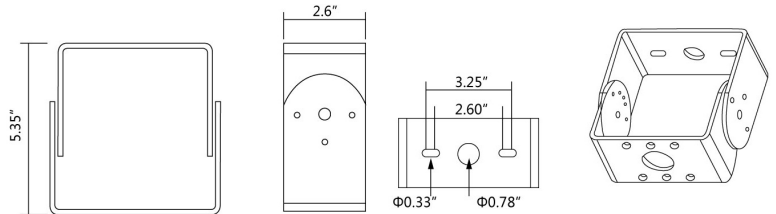

ARM DIMENSIONS

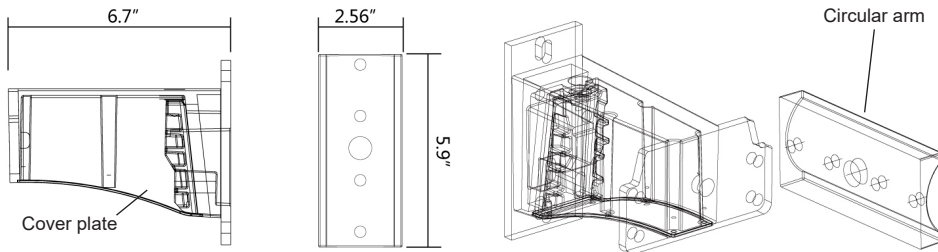

SLIP FITTER ADAPTOR

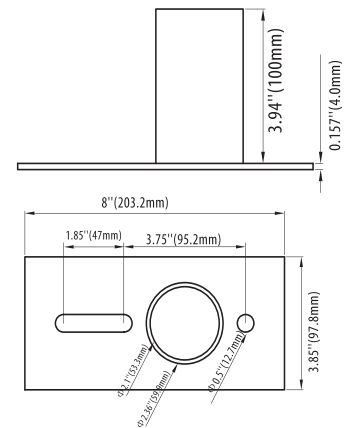

INSTALLATION INSTRUCTIONS

ARM MOUNTING INSTRUCTIONS FOR SQUARE POLE

Step 1: Open the cover plate on the arm mount, separate the nut plate from the arm mount by sliding it out. Drill holes on the square pole corresponding to the holes on the nut plate, and use the bolts to fix the nut plate to the pole tightly. Then slide the fixture into the nut plate, tighten the screw on top of the arm mount to secure the fixture

Step 2: Connect the AC wire of the fixture and tighten the water-proof gasket and cover plate on the arm by screws, then power on

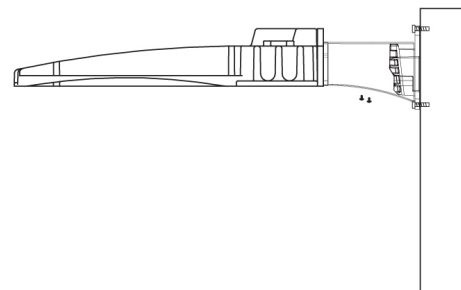
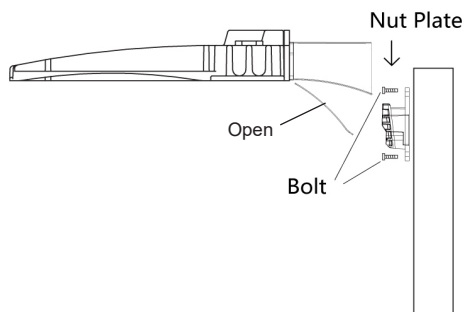

ARM MOUNTING INSTRUCTIONS FOR ROUND POLE

Step 1: Open the cover plate on the arm mount, separate the nut plate from the arm mount by sliding it out. Drill holes on the round pole corresponding to the holes on the nut plate and the circular arm add-on, and use the bolts to fix the nut plate and add-on to the pole tightly. Then slide the fixture into the nut plate, tighten the screw on top of the arm mount to secure the fixture.

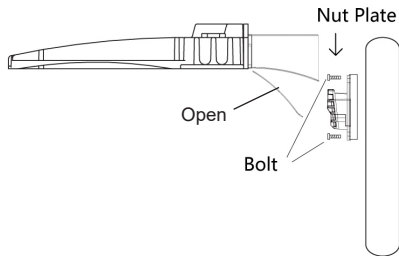

Step 2: Connect the AC wire of the fixture and tighten the water-proof gasket and cover plate on the arm by screws, then power on.

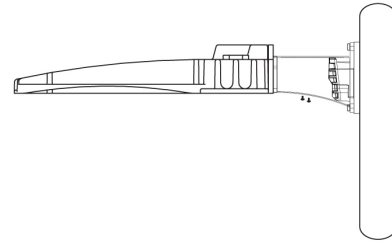

SLIP FITTER MOUNTING INSTRUCTIONS

Step 1: Connect the AC wire, and then insert the arm of the slip fitter to the pole.

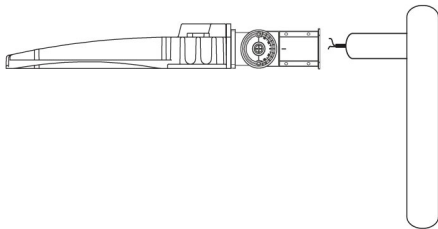

Step 2: Tighten the screws on the side of the arm and then power on.

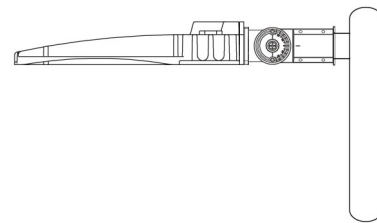

TRUNNION MOUNTING INSTRUCTIONS

Step 1: Drill two holes on the wall corresponding to the holes on the trunnion, and knock expansion screws into the holes.

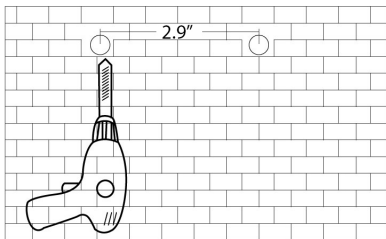

Step 2: Use the nuts to fix the fixture to the wall aiming at the expansion screws and adjust angle of the bracket and tighten the small screw on the side, then connect the AC wire.

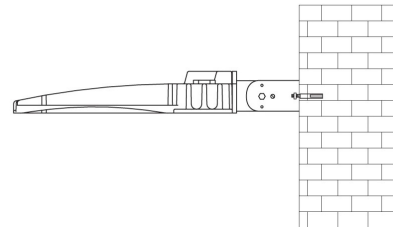

PHOTOMETRIC REPORT

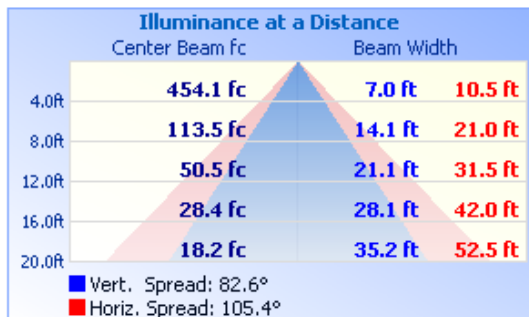

Zonal Lumen Summary		
Zone	Lumens	% Luminaire
0-30	7,127.3	20.2%
0-40	13,498.7	38.2%
0-60	29,156.2	82.6%
60-90	6,111.6	17.3%
70-100	1,449.3	4.1%
90-120	11.4	0%
0-90	35,267.7	99.9%
90-180	40.2	0.1%
0-180	35,307.9	100%

